

# REDS

*Racing*

## R5R RACER

FACTORY TUNED  
V4.0 February 2017



Recommended for  
1/8 Buggy and Truggy

ES214801  
CARB 3.5CC R SERIES SET HCX  
(venturi not included)

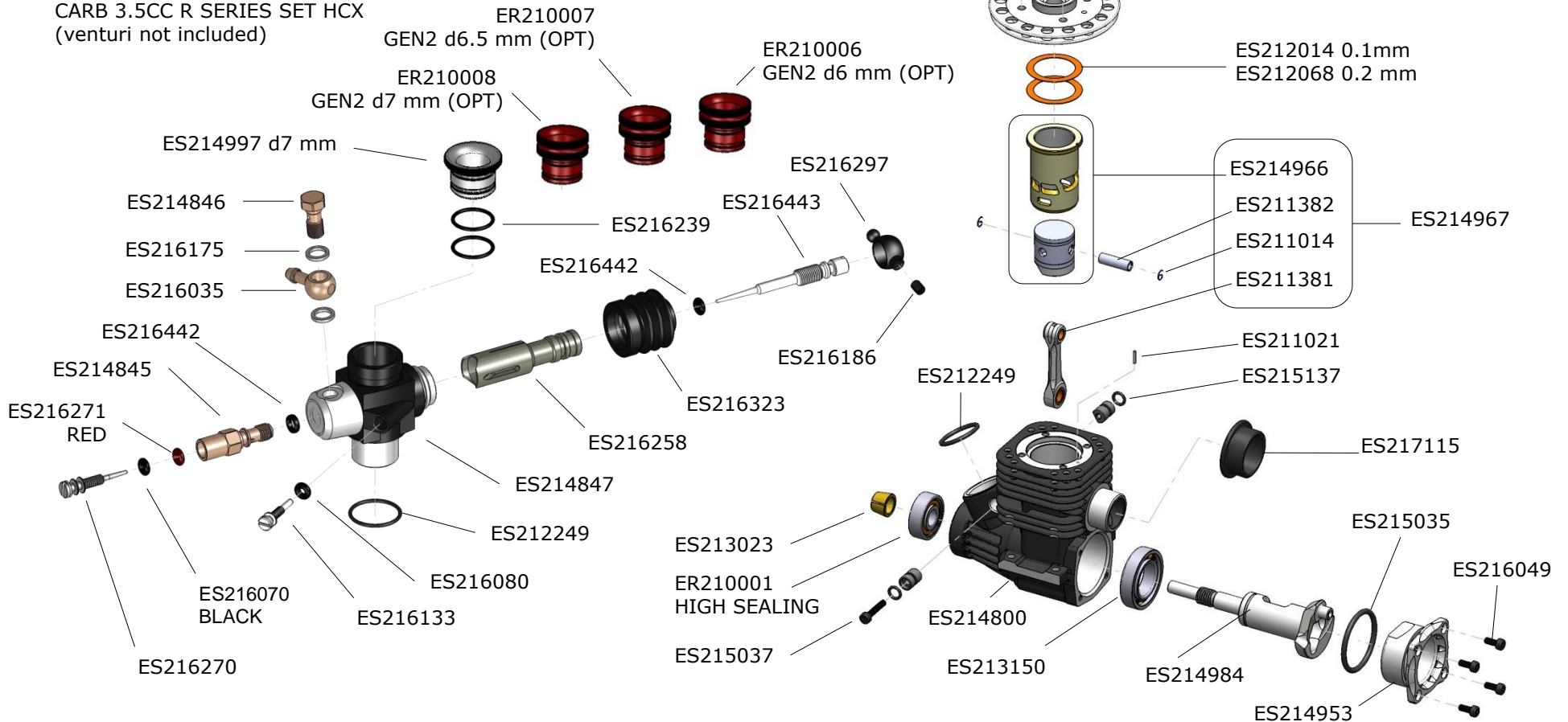

# REDS

## Racing

### R5R OPTIONALS

**QUATTRO CLUTCH**  
ADJUSTABLE, PRE ASSEMBLED  
OFF ROAD CLUTCH SYSTEM  
100% MADE IN ITALY



**MA210058** PIPE REDS EFRA 2113  
Recommended M or S manifold  
Great bottom/mid/top power, average runtime



**MA210059** PIPE REDS EFRA 2112  
Recommended M or S manifold  
Good bottom/mid power, good runtime



**MM0003**  
SPRING PIPE (9PC)  
**MM0001**  
SPRING ENGINE M (4PC)  
**MM0002**  
SPRING ENGINE L (4PC)

**MA212104** PIPE REDS EFRA 2104  
Recommended S or XS Manifold  
Smooth power, best runtime



**GM0001** PIPE GASKET  
3.5CC M/R SERIES (2PC)

**ES217115** ENGINE  
GASKET 3.5CC M/R  
SERIES (2PC)

**CL210059** MANIFOLD REDS M MEDIUM  
**CL210078** MANIFOLD REDS S SHORT  
**CL210500** MANIFOLD REDS XS X-SHORT  
**KM210005** PIPE 2112 + MANIFOLD S KIT  
**KM210006** PIPE 2113 + MANIFOLD S KIT  
**KM210007** PIPE 2104 + MANIFOLD S KIT



**TS3**  
ULTRA HOT TURBO  
SPECIAL - JAPAN  
Ambient Temp.:  
0 - 25 ° C



**TS4**  
SUPER HOT TURBO  
SPECIAL - JAPAN  
Ambient Temp.:  
15 - 40 ° C